

Wall Speaker

SWS-03/03A/10/10A



SPECIFICATIONS

	SWS-03	SWS-03A	SWS-10	SWS-10A
Rated Input	3W	3W	10W	10W
Impedance	COM	COM	COM	COM
	3,3k Ω	3,3k Ω	1k Ω	1k Ω
	5k Ω	5k Ω	2k Ω	2k Ω
	10k Ω	10k Ω	3,3k Ω	3,3k Ω
	-	Rotary switch	-	Rotary switch
Frequency Response	200Hz ~ 14kHz		160Hz ~ 10kHz	
SPL(1M/1W)	93dB		91dB	
Weight(SET)	1,1kg/2,4lb		1,34kg/2,95lb	
Dimensions(SET)	182(W)x274(H)x120(D)mm 7,2(W)x10,8(H)x4,7(D)in			

* Design and specification are subject to be changed for the improvement of product quality without pre notice.

interM

WALL SPEAKER

SWS-03/03A/10/10A

Drawing

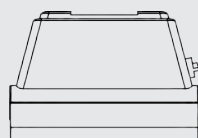

TOP

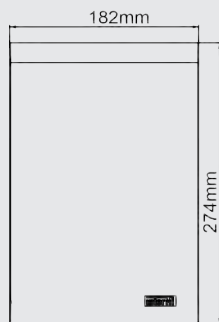

FRONT

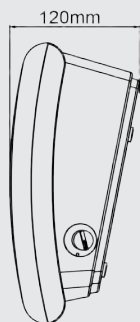

SIDE

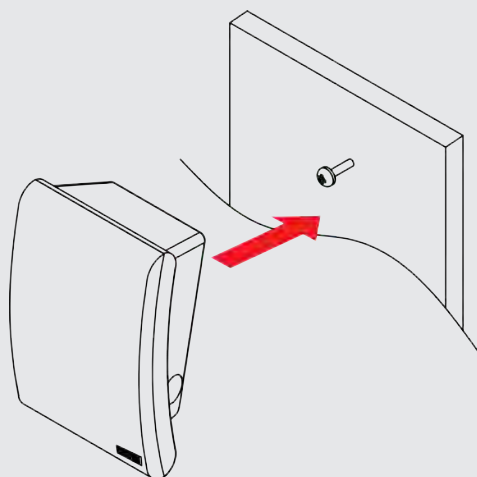

Frequency Response

► SWS-03/03A

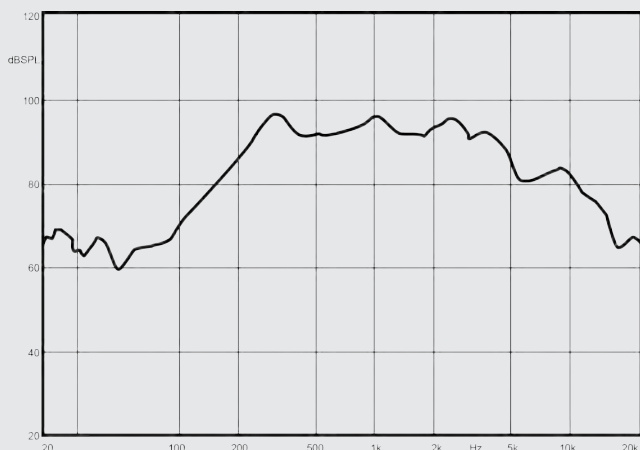

► SWS-10/10A

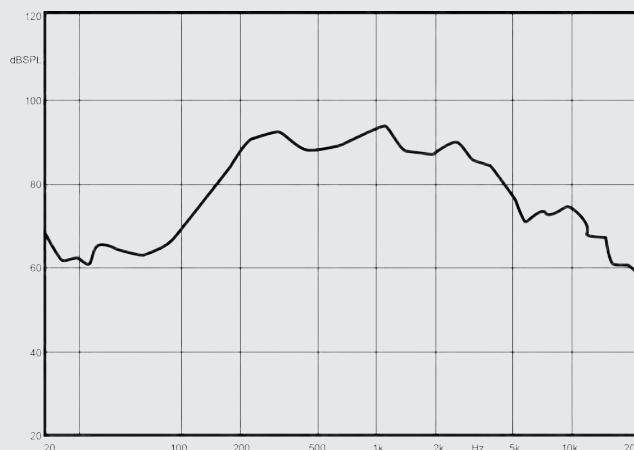

Inter-M Corporation

- Office : 719, DOBong -RO, DOBong -g u , SEouL, KOREA
 - Tel : +82-2-2289-8140~8, Fax : +82-2-2289-8149
 - Home page: <http://www.inter-m.com>, E-mail: overseas@inter-m.com

Inter-M Corp. (IMA)

- Office : 5666 CORPORATE Av E. Cy PRESS, CA 90630
 - Tel : +1-714-828-2200, Fax : +1-714-828-2210
 - E-mail : info@inter-m.net, Home Page : www.inter-m.net